

DO NOT SCALE

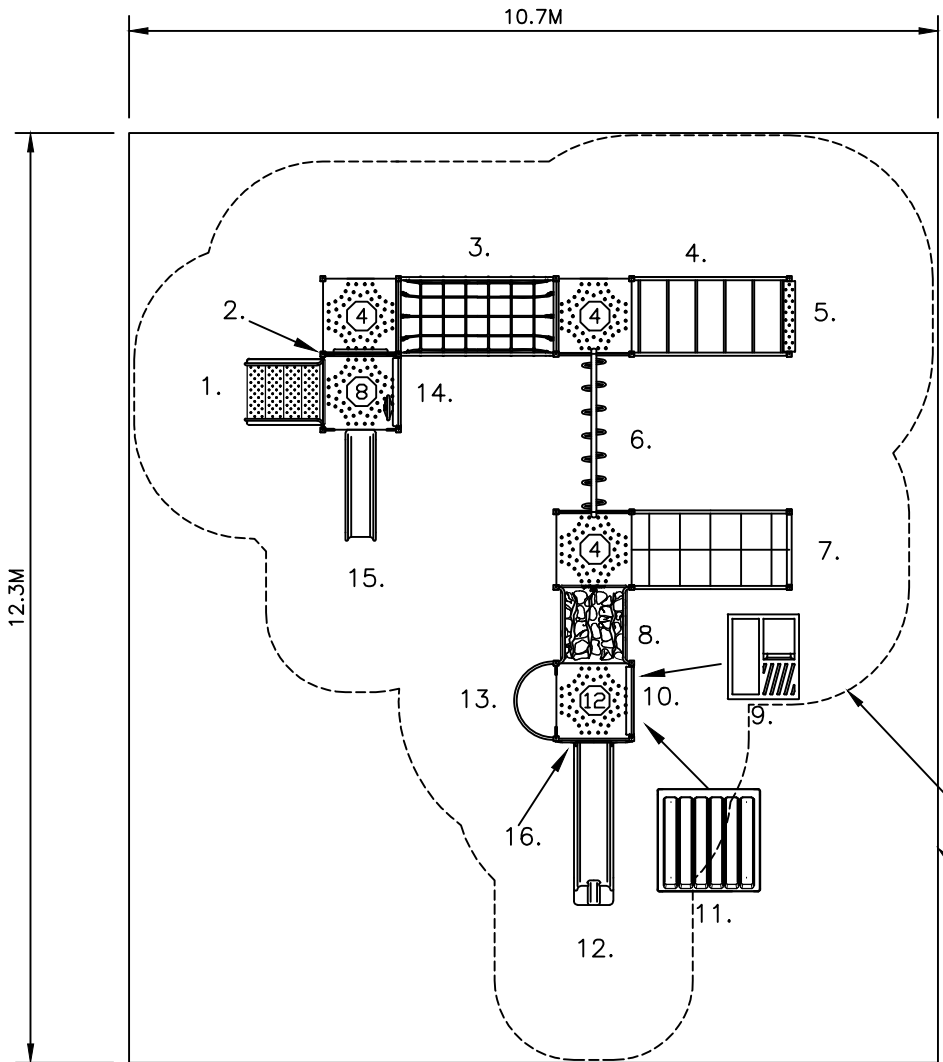

1. SAFETY STAIRS DK-GRND 800
2. STEP PANEL & SAFETY LOOPS
3. COMMANDO BRIDGE DK-DK
4. CHALLENGE LADDER
5. SAFETY STEP
6. RING TREK
7. BURMEZE ROPE BRIDGE DK-PST
8. ROCKY RAMBLE DK-DK 800
9. SHOP FRONT PANEL (UNDER)
10. OBLIQUE PANEL
11. ARC ROOF
12. CATERPILLAR SLIDE 1200 (NO HOOD)
13. FIREPOLE 1200
14. PLASTIC OBLIQUE PANEL WITH WHEEL
15. CATERPILLAR SLIDE 800
16. SLIDE ENTRY PANEL

SAFETY ZONE*

SOFT FALL AREA

522-DAN
MAX FHF: 2.2M

SCALE = mm

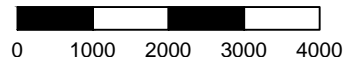

*AS 4685:2014

APPROX AREA (sq.m.): 131.6 APPROX PERIMETER (lin.m.): 46.0

DISTRIBUTED BY

AUSTEK PLAY
1300 433 364
WWW.AUSTEKPLAY.COM.AU
INFO@AUSTEKPLAY.COM.AU

522 - DAN
EXTREME UNIT
STANDARD DRAWING

| | | |
|------------------|--------------|--------|
| DRAWING No.: 522 | | REV: A |
| DRN: A. DYSON | SCALE 1:100 | SIZE |
| DATE: 30/07/14 | SHEET 1 OF 1 | A4 |

- Heights above Playground surface are shown on decks and all play equipment, is. Ⓢ = 400mm
- Impact absorbing ground cover is required under and around all play equipment.
- The min. recommended fall zone around the entire play structure is shown. This zone is to be free of all tripping or collision hazards (ie. roots, rocks, border material, etc).
- Site layout and dimensions are subject to verification prior to installation.
- Dimensions in millimetres unless stated otherwise.