

DO NOT SCALE

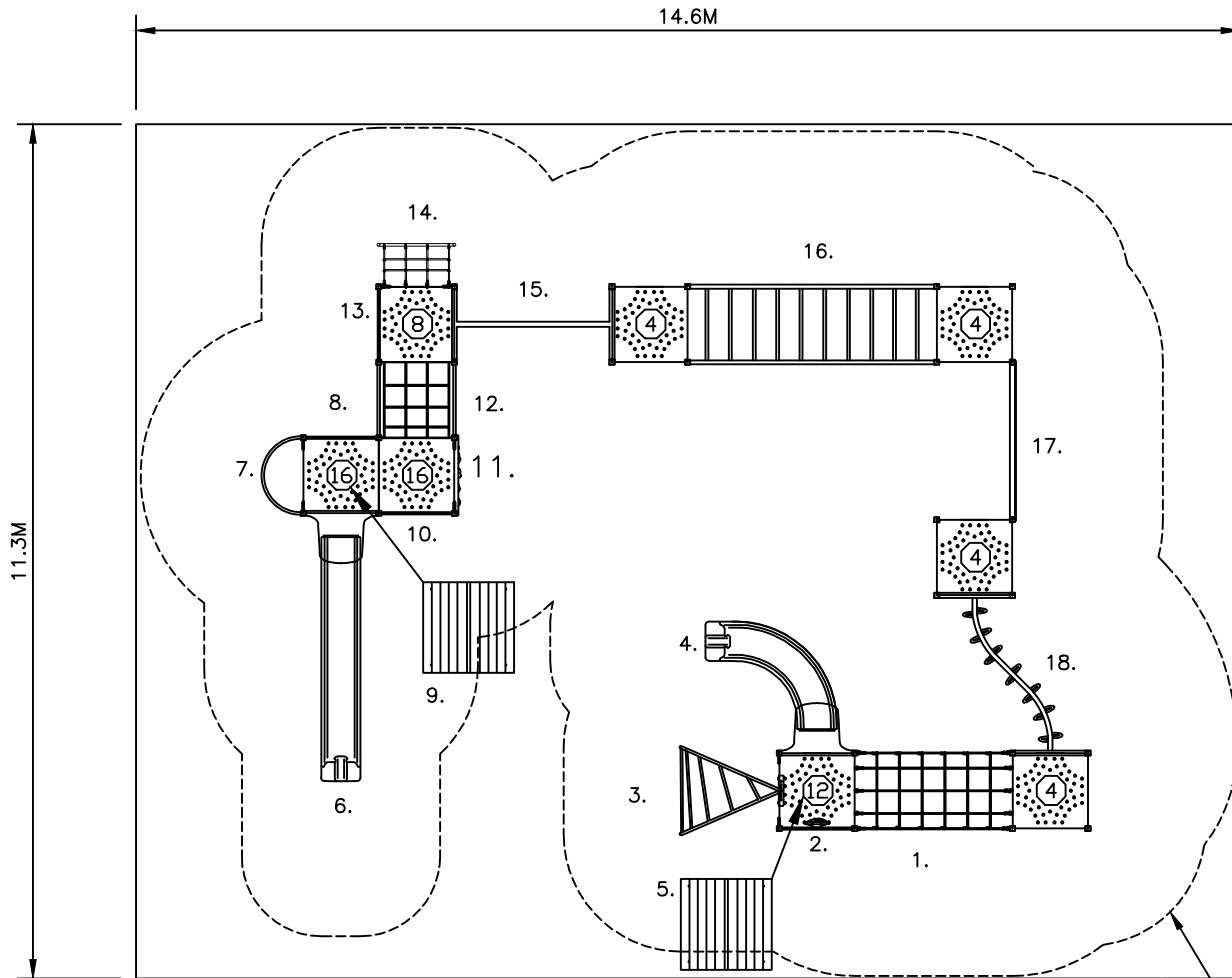

1. INCLINED ROPE BRIDGE DK-DK
2. SAFETY RAIL PANEL W/ WHEEL
3. TWISTED CHALLENGE LADDER
4. HOODED CURVED CATERPILLAR SLIDE
5. PLASTIC CUBBY ROOF
6. HOODED CATERPILLAR SLIDE 1600
7. FIREPOLE 1600
8. SAFETY RAIL PANEL
9. PLASTIC CUBBY ROOF
10. SAFETY RAIL PANEL
11. ROCK WALL CHALLENGE
12. CARGO NET CLIMBER DK-DK 800
13. SAFETY RAIL PANEL
14. CARGO NET CLIMBER DK-GND 800
15. INCLINED ROPE SCRAMBLE
16. TWISTED CHALLENGE LADDER
17. SPIDER WEB CLIMBER
18. RING TREK 'S'

571 - CASEY  
MAX FHF: 2.2m

SAFETY ZONE\*  
SOFT FALL AREA

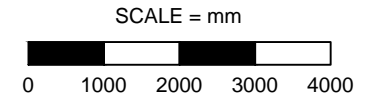

\*AS 4685:2014

APPROX AREA (sq.m.): 165.0 APPROX PERIMETER (lin.m.): 51.8

DISTRIBUTED BY



AUSTEK PLAY  
1300 433 364  
WWW.AUSTEKPLAY.COM.AU  
INFO@AUSTEKPLAY.COM.AU

571 - CASEY  
EXTREME UNIT  
STANDARD DRAWING

DRAWING No.: 571

REV: A

DRN: A. DYSON  
DATE: 10/09/14

SCALE 1:100  
SHEET 1 OF 1

SIZE  
A4

- Heights above Playground surface are shown on decks and all play equipment, is. Ⓢ = 40mm
- Impact absorbing ground cover is required under and around all play equipment.
- The min. recommended fall zone around the entire play structure is shown. This zone is to be free of all tripping or collision hazards (ie. roots, rocks, border material, etc).
- Site layout and dimensions are subject to verification prior to installation.
- Dimensions in millimetres unless stated otherwise.

OMNITECH PLAYGROUNDS - ABN 88 004 660 495 - PH 1800 812 027 - WEB WWW.OMNITECH.COM.AU - EMAIL INFO@OMNITECH.COM.AU - THIS DRAWING IS THE PROPERTY OF OMNITECH PLAYGROUNDS, REPRODUCTION IS PROHIBITED WITHOUT WRITTEN CONSENT.

