

DO NOT SCALE

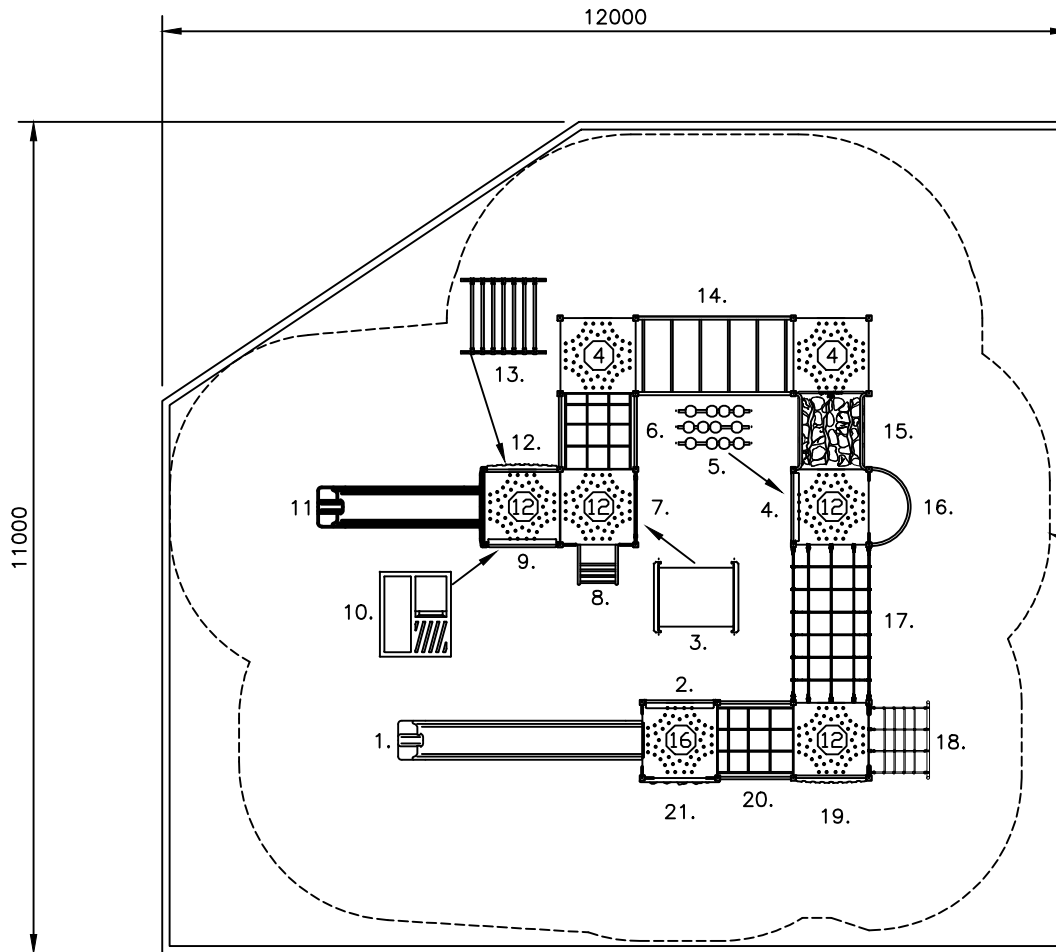

1. CATERPILLAR SLIDE (NO HOOD)
2. PLASTIC OBLIQUE PANEL
3. 1M CRAWL TUBE (UNDER)
4. PLASTIC OBLIQUE PANEL
5. ABACUS PANEL (UNDER)
6. CARGO CLIMBER (ROPE) DK-DK 800
7. EDU/PICTURE PANEL
8. VERTICAL LADDER 1200
9. PLASTIC OBLIQUE PANEL
10. SHOP FRONT PANEL (UNDER)
11. CATERPILLAR SLIDE (NO HOOD)
12. WIGGLY PANEL
13. SQUEEZE BARS (UNDER)
14. CHALLENGE LADDER
15. ROCKY RAMBLE DK-DK 800
16. FIREPOLE 1200
17. ROPE BRIDGE
18. CARGO CLIMBER GRND-DK 1200
19. WIGGLY PANEL
20. CARGO CLIMBER (ROPE) DK-DK 400
21. ROCK WALL CHALLENGE 1600

SAFETY ZONE

PROPOSED TIMBER BORDER

SCALE = mm

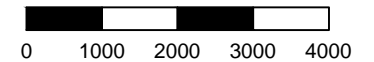

APPROX AREA (sq.m.):121.8 APPROX PERIMETER (lin.m.):43.4

2012 SCHOOL RANGE  
 LARGE UNIT  
 (VARIATION OF STANDARD DWG 512)

DRAWING No.:SR06

REV: A

DRN: B.Crichton  
 DATE: 29/02/12

SCALE 1:100  
 SHEET 1 OF 1

SIZE  
 A4

- Heights above Playground surface are shown on decks and all play equipment. is. Ⓞ = 400mm
- Impact absorbing ground cover is required under and around all play equipment.
- The min. recommended fall zone around the entire play structure is shown. This zone is to be free of all tripping or collision hazards (ie. rocks, roots, border material, etc).
- Site layout and dimensions are subject to verification prior to installation.
- Dimensions in millimetres unless stated otherwise.

