

### DSW 4904/4954 Horizontal Ladder technical information

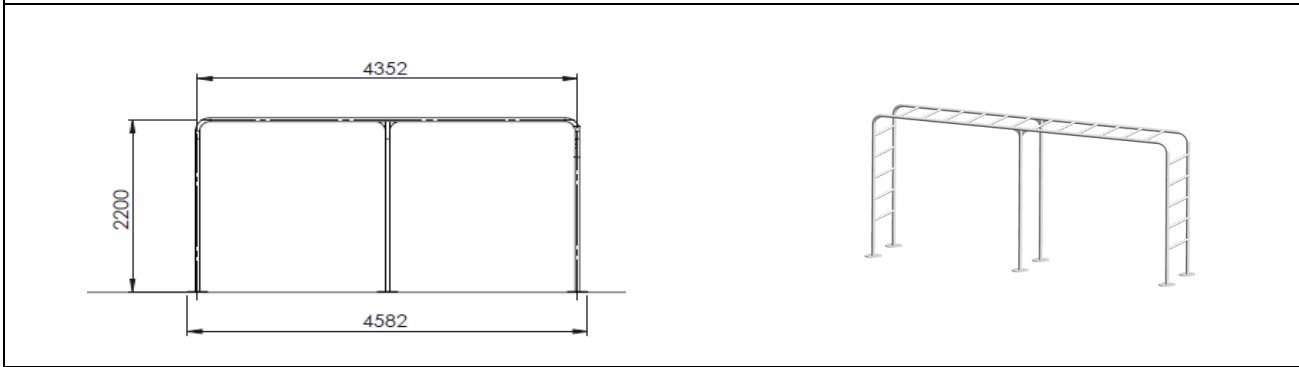

		<b>Bars</b>	
<b>Material</b>		steel, hot dipped galvanized	
<b>Dimensions</b>	Bars: $\varnothing 33,7/48,3 \times 3,25$ mm		
<b>Area of movement</b>	41,5 m <sup>2</sup>		
<b>free height of fall</b>	1200 mm		
<b>Fall protection according EN16630</b>	No		
<b>intended for</b>	youth and adults >1400 mm		
<b>max. user weight</b>	120 kg		

**Anchoring** 750 mm in the ground with  $\varnothing 230$  and  $\varnothing 115$  mm frames  
 The installation frames need to be secured with fast-setting concrete. Every hole should be 500x500x750mm and around 0,12m<sup>3</sup> concrete is needed. The soil should be packed tightly. Follow the instructions in the installation manual.

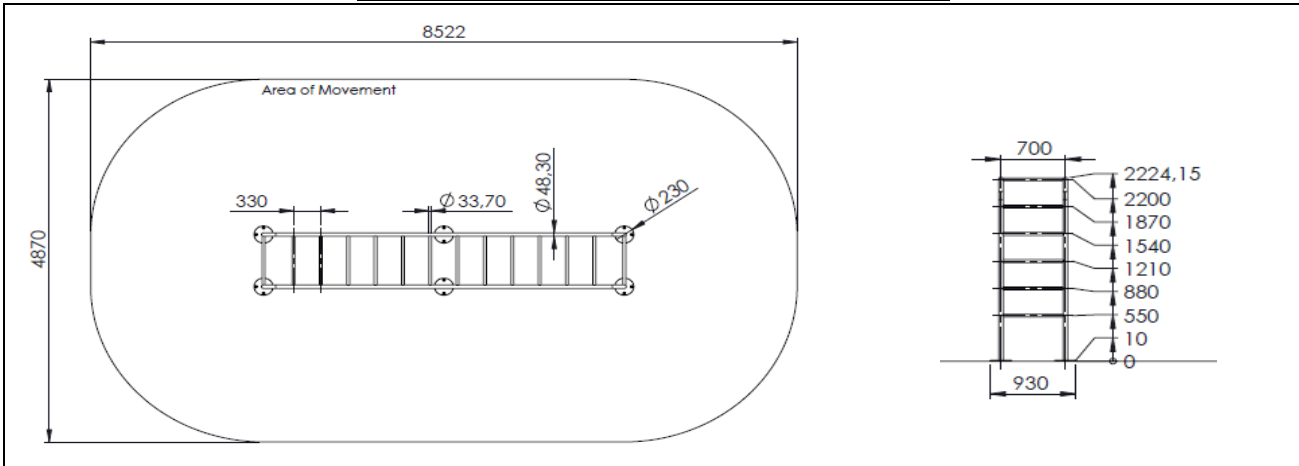
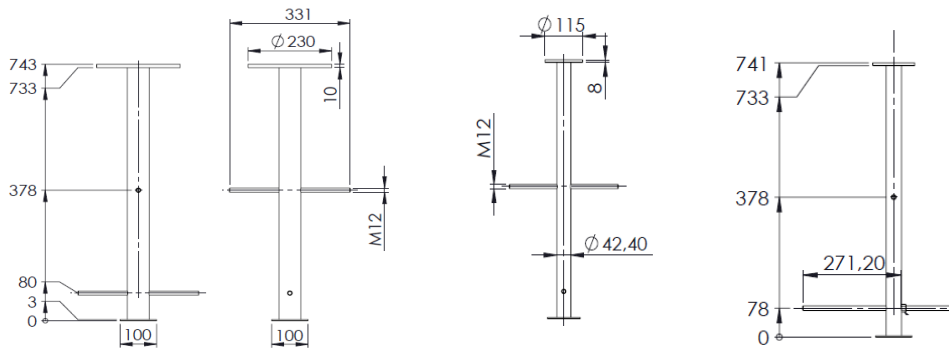

**On concrete: with  $\varnothing 230$  or 115 mm ground plate**  
 Chemical anchoring needs to be used; this is not included.  
 Follow the instructions in the installation manual.

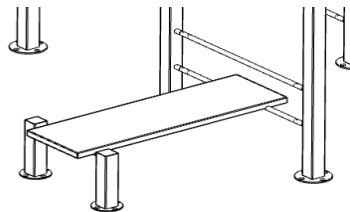

Notice:

*Not intended for children < 1400 mm*  
*The Denfit StreetWorkout equipment should not be used if you are suffering from physiological problems.*  
*Avoid exaggerated physical exhaustion. In case of doubt please contact your doctor before use.*  
*Inspect the equipment before use. Don't use it if it appears damaged or inoperable.*

Certification:

**EN16630:2015 - for permanently installed outdoor fitness equipment**