

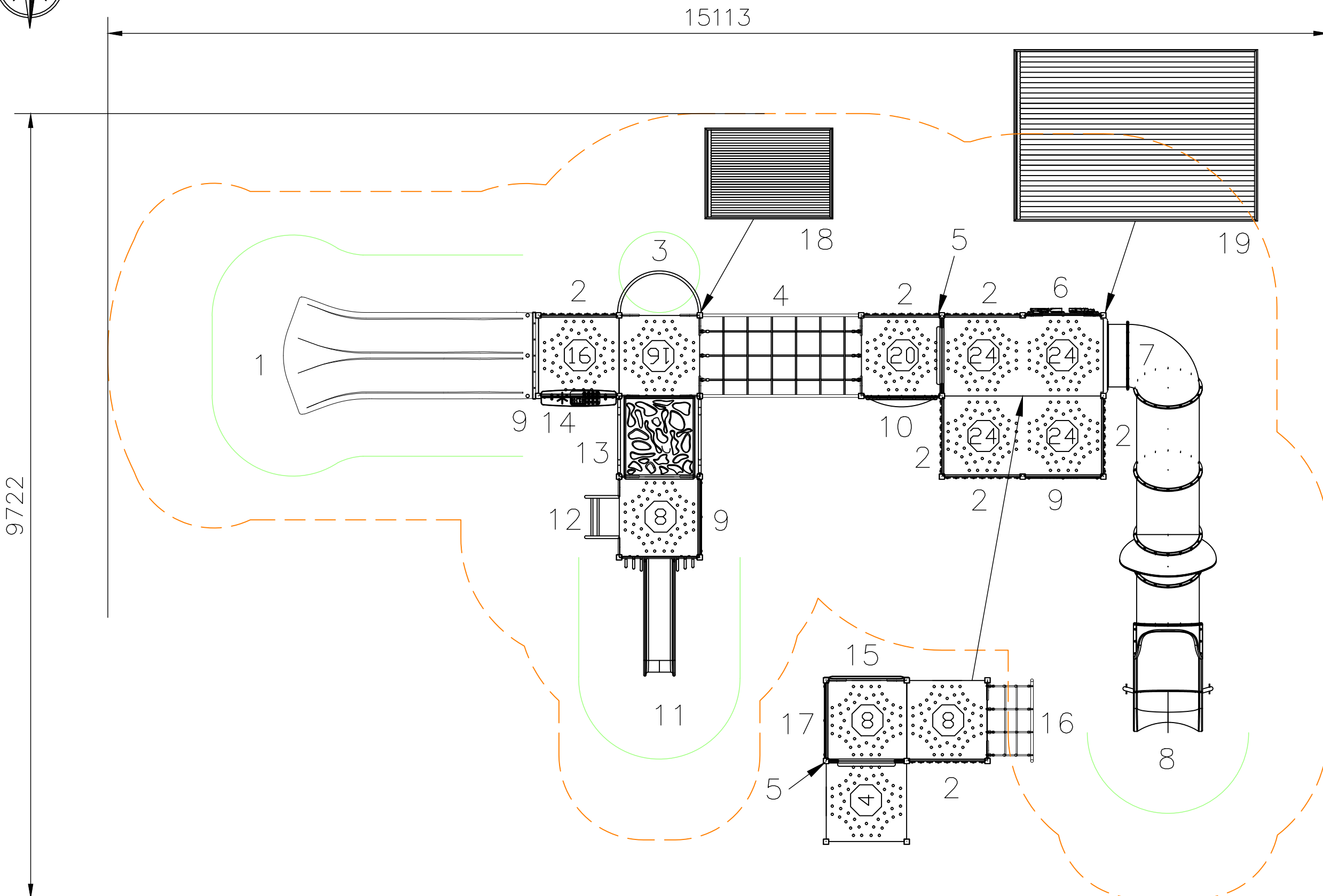

**EQUIPMENT LIST**

RAPH

1. DOUBLE WIDE SLIDE 1600
2. UNIVERSAL COMPOSITE TIMBER PICKET PANEL (MG) X7
3. FIREPOLE 1600 & BARRIER ENTRY LOOPS - RAIL (MG)
4. INCLINED ROPE BRIDGE DCK-DCK 400 (2M) BARRIER ENTRY LOOPS - RAIL (MG) X2
5. STEP PANEL\_LOOPS X2
6. ROCKWALL CLIMBER 2400 (MG) & BARRIER ENTRY LOOPS - RAIL (MG)
7. HOLE PANEL Ø760 (MG)
8. ELBOW TUBE SLIDE 2400
9. MODERN PANEL (MG)
10. CNC BUBBLE PANEL (MG)
11. CATERPILLAR SLIDE - ENTRY PANEL 800
12. VERTICAL LADDER 800 & BARRIER ENTRY LOOPS - RAIL (MG)
13. MG ROCKY RAMBLE DCK-DCK 800 & BARRIER ENTRY LOOPS - RAIL (MG) X2
14. COUNTER PANEL (MG)
15. RAIL LADDER 800 & BARRIER ENTRY LOOPS - RAIL (MG)
16. CARGO CLIMBER DCK-GND 800 & BARRIER ENTRY LOOPS - RAIL (MG)
17. PLANETS PANEL (MG)
18. SKILLION ROOF 1X1M
19. SKILLION ROOF 2X2M



**EXTREME COLOURS: CARNIVAL**

- POSTS - SILVER GLOSS
- POST CAPS - RED
- RAILS - HUNTER BLUE
- PLASTIC 1 - MAGENTA
- PLASTIC 2 - APPLE GREEN
- ROPES - BLACK
- CNC PANEL - LIME GREEN/BLACK & DARK BLUE/WHITE
- CNC ROCKWALL - LIME GREEN/BLACK

QUANTITIES	QTY TOTAL

NOTES:  
 - Heights above Playground surface are shown on decks and all play equipment. ie. Ⓞ = 400mm  
 - Impact absorbing ground cover is required under and around all play equipment.

- The min. recommended fall zone around the entire play structure is shown. This zone is to be free of all tripping or collision hazards (ie. roots, rocks, border material, etc).  
 - Site layout and dimensions are subject to verification prior to installation.  
 - Dimensions in millimetres unless stated otherwise.

